

**Acme Sanitary Ware Co Ltd**

Acme Building, 22-28 Nanking Street, Kowloon, Hong Kong
 Tel: 2388 7171 Fax: 2710 8012
 E-mail: acme@acmesanitary.com.hk
 Website: www.acmesanitaryware.com.hk

**American
Standard**

PROJECT		REF		REV	ITEM CODE	
LOCATION		DATE			PAGE	

SANITARY WARE SPECIFICATION SHEET

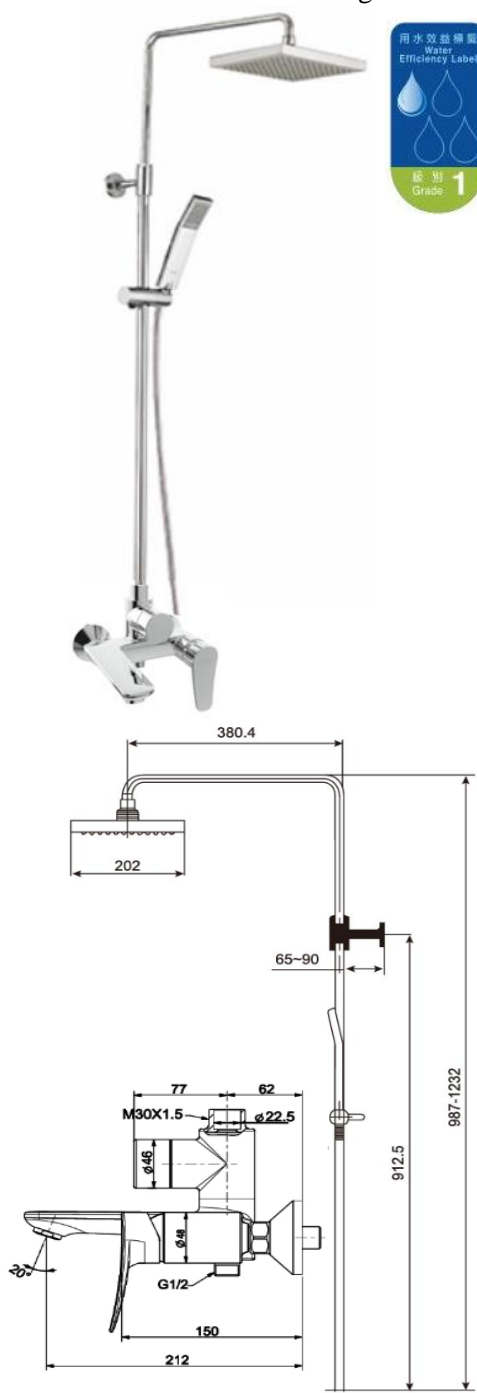
Item Descriptions	American Standard (PRC) "Milano" Chrome plated exposed bath & rain shower mixer with "Moonshadow" chrome plated rainshower system, D200AS comprising 202mm diameter rainshower ; single functions hand shower with nominated flow rate 7.8 L/min & 8.0 L/min in WELS Grade 1 ; Registration No. SB 18-0090 & SB 20-0031	<div>Illustration/ Drawing</div> 
Model	CF-9082.000.50 (Rain Shower System) CF-0972.702.50 (Mixer)	
Finish	Chrome Plated	
Manufacturer	American Standard (PRC)	
Source	Acme Sanitary Ware Co. Ltd Mr. Eric Wong / Mr. Don Yuen	
Contact Tel/Fax	(852) 2388-7171 / (852) 2710-8012	
E-mail	acme@acmesanitary.com.hk	
Website	www.acmesanitary.com.hk	

Hand Shower

Dynamic flow pressure (kPa)	50	150	250	350	500
Flow rate (l / min)	4.15	7.40	7.80	8.10	8.40

Head Shower

Dynamic flow pressure (kPa)	50	150	250	350	500
Flow rate (l / min)	3.85	6.70	8.20	9.20	10.50

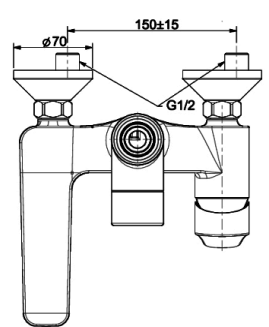
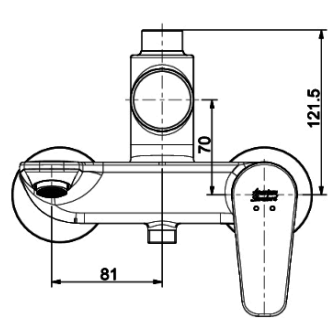

Note: Same product but different model no:

WF-0972.702.50 (PRC) or FFAS0972-702500BC0

* All information of the above is for the reference only. No prior notice is made if any changes.

註冊號碼 (Registration No.): SB 18-0090



自願參與用水效益標籤計劃 - 沐浴花灑
Voluntary Water Efficiency Labelling Scheme - Showers for Bathing



茲證明
This is to certify that

將下列花灑在本計劃內註冊：
has registered the following shower under this scheme:

牌子 / Brand	:	American Standard
型號 / Model	:	CF-9H03.000.50
原產地 / Country or Region Origin	:	China

在用水效益標籤上展示的標誌 <i>Symbolic Presentation on the Water Efficiency Label</i>	:	 滴水點 <i>Water droplet(s)</i>
用水效益級別 <i>Water Efficiency Grade</i>	:	1
耗水量 <i>Water Consumption</i>	:	7.8 公升/分鐘 <i>litres/minute</i>

簽發日期: 27 April 2018
Date of Issue:



水務署
Water Supplies Department



水務署署長(周世威代行)
for Director of Water Supplies



自願參與用水效益標籤計劃 - 沐浴花灑
Voluntary Water Efficiency Labelling Scheme - Showers for Bathing



茲證明

This is to certify that

將下列花灑在本計劃內註冊：
has registered the following shower under this scheme:

牌子 / Brand	:	American Standard
型號 / Model	:	1582300650
原產地 / Country or Region Origin	:	China

在用水效益標籤上展示的標誌 <i>Symbolic Presentation on the Water Efficiency Label</i>	:	 滴水點 <i>Water droplet(s)</i>
用水效益級別 <i>Water Efficiency Grade</i>	:	1
耗水量 <i>Water Consumption</i>	:	8.0 公升/分鐘 <i>litres/minute</i>

簽發日期: 21 August 2020
Date of Issue:



水務署
Water Supplies Department



水務署署長(張業駒代行)
for Director of Water Supplies



水務署

Water Supply

香港灣仔告士打道
Immigration Tower, , Kong



電子郵遞

e-mail

wsdinfo@wsd.gov.hk

圖文傳真

Facsimile

2824 0578

檔號

Reference

(2) in WSD 3321/18 Pt.1 T/J(333)

4 May 2018

Dear Sir,

Approval of "AMERICAN STANDARD" Bath/Shower Mixers

Your letter ref. WRC/1679 dated 29 March 2018 refers.

Having considered the test report ref. J21676 issued on 12 March 2018 by Nutek Systems (HK) Ltd., this Authority accepts that the fittings described below comply with, and their use when correctly installed does not contravene, the Waterworks Ordinance and Regulations.

Name of Manufacturer: American Standard

Country of Origin: China

Brand: American Standard

Details of Fittings: 1/2" Single lever bath and shower mixer

Model: CF-0972.70X.50
WF-0972.70X.50
(where "X" denotes the code of handle)

Body Markings: *American Standard*

Expiry Date:

27 July 2022

This Authority hereby permits the use of the above fittings in fresh water plumbing systems subject to full adherence to Waterworks installation requirements. In particular, you are required to draw your customers' attention to the following requirement-

"The cold water supply to the fittings shall be drawn from the same source that supplies the hot water apparatus so as to provide a balanced pressure and to obviate the risk of scalding in the event of a restriction or failure in the water supply." AND

"The shower head or handspray should not be placed in submerged conditions and should be securely fixed to the original position after use."

A condition of this acceptance is that the fittings to be installed shall be replicas of the samples as certified by the testing agent mentioned above and without modifications. This acceptance may be withdrawn at any time if the standard of the fittings installed fails to meet that of the approved samples or if the fittings are found to be unsuitable for use in fresh water plumbing systems.

This acceptance is only applicable to the main body of the fittings, unless other specified.

For the use of the fittings in any project, the Acceptance Reference Number at the bottom of this letter must be quoted as a means of identification of acceptance of the fittings by this Authority.

Should you have any enquiries, please contact our Engineer Mr. Terry KUNG at tel. no. 3583 4086.

Yours faithfully,



(CHAN Chung Kun)
for Water Authority

c.c. WSD 3321/1/82] - without catalogue
 ME/MC] - with soft copy only

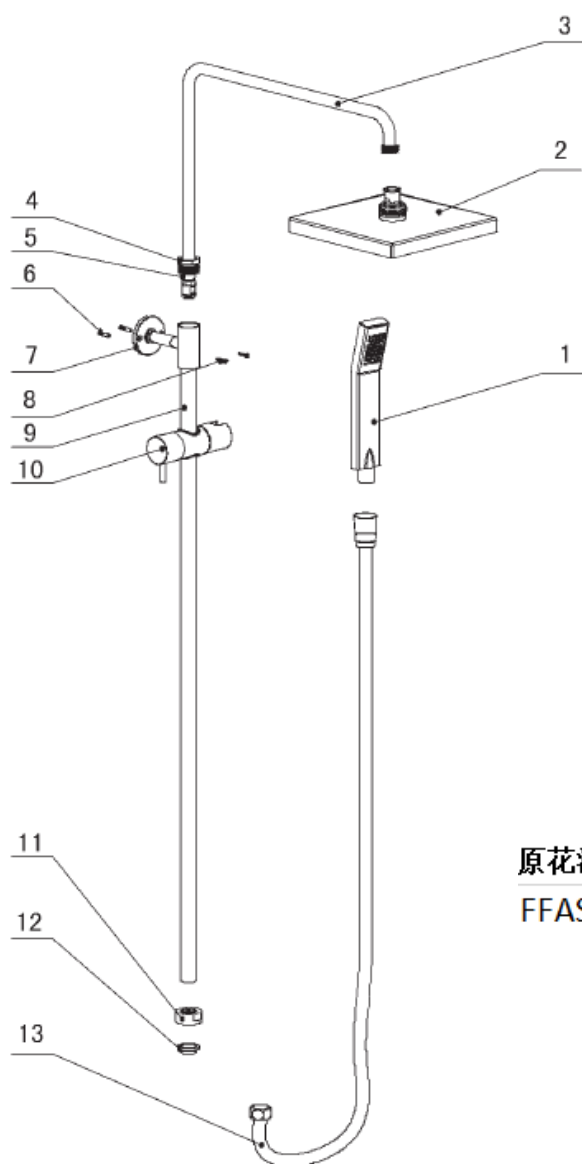

零件编号	零件名称	包装数量
1582300850	手握花洒	1
1582300650	头部花洒	1
1585462250	弯管	1
1580490350	锁紧螺母	1
1582386899	开口环	1
158M905767	膨胀管	1
159Z000303	墙座	1
1581881799	自攻螺钉	1
1585462350	直管	1
1585222050	滑座	1
1580490450	对边螺母	1
1581175699	密封垫圈	1
1582006150	软管	1

原花洒头型号(独立花洒头)

FFAS9H03-000500BC0

Old Code

CF-9H03.000.50

